

MR-2300-NC4/2 Output Class-A Converter Adder Module

The Model MR-2300-NC4 Output Class A Converter Adder Module is used to convert 4 Class B output circuits in the MR-2306 Fire Alarm Panel to 4 Class A output circuits. It mounts under the MR-2306 main fire alarm board near the output terminal blocks on the right hand side.

The Model MR-2300-NC2 Output Class A Converter Adder Module is used to convert 2 Class B output circuits in the MR-2306 Fire Alarm Panel to 2 Class A output circuits. It mounts under the MR-2306 main fire alarm board near the input terminal blocks.

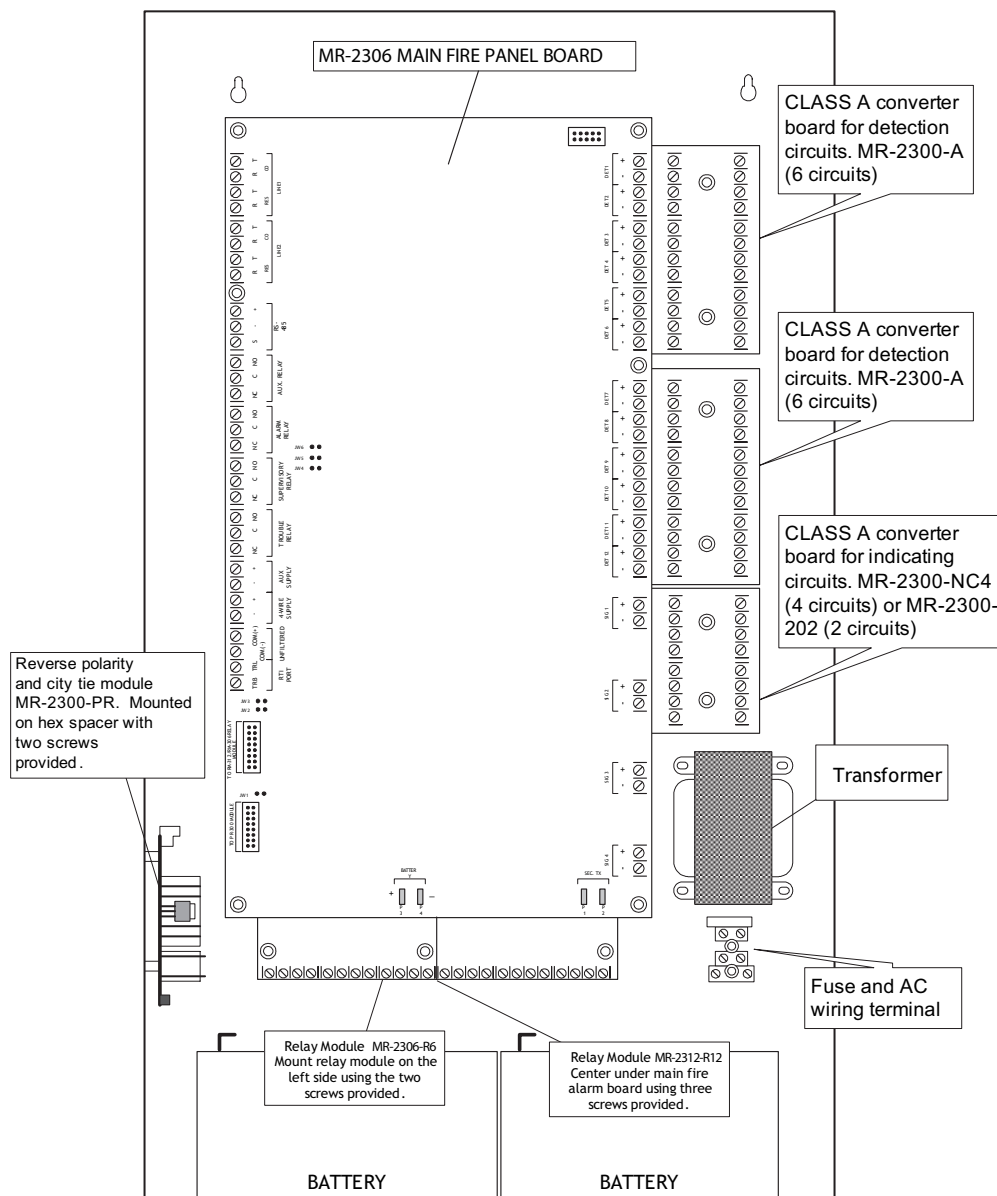

MR-2300-NC4/2 Output Class A Converter Adder Modules

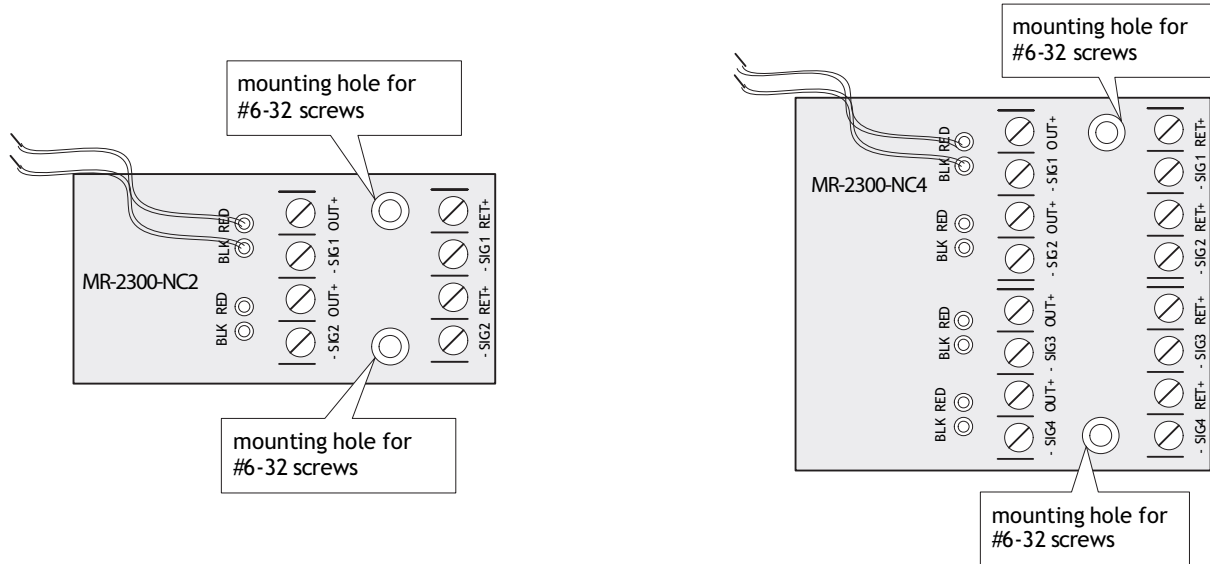

Indicating circuits must be wired from the MR-2300-NC4/2 to the main Fire Alarm board. For example indicating circuit 1 positive (red wire) and negative (black wire) is wired from the Class A converter module to the positive and negative terminals of Indicating circuit 1 on the Main Fire Alarm board.

The actual indicating zone is wired from the SIGNAL OUT positive and negative to the signaling devices and then wired back to the SIGNAL RET positive and negative.

ELECTRICAL SPECIFICATIONS:

Current Consumption: Standby: 0 mA

Alarm: 0 mA

Canada

25 Interchange Way
Vaughan, ON L4K 5W3
Tel: (888) SECUTRON
(888) 732-8876
Fax: (905) 660-4113

U.S.A

60 Industrial Parkway, PMB 278
Cheektowaga, New York 14227
Tel: (888) SECUTRON
(888) 732-8876
Fax: (905) 660-4113



www.secutron.com

LT-1006SEC JAN 2006